

# iHome®

Model iP57  
**Portable Rechargeable  
Stereo Speakers for your  
iPhone/iPod®**

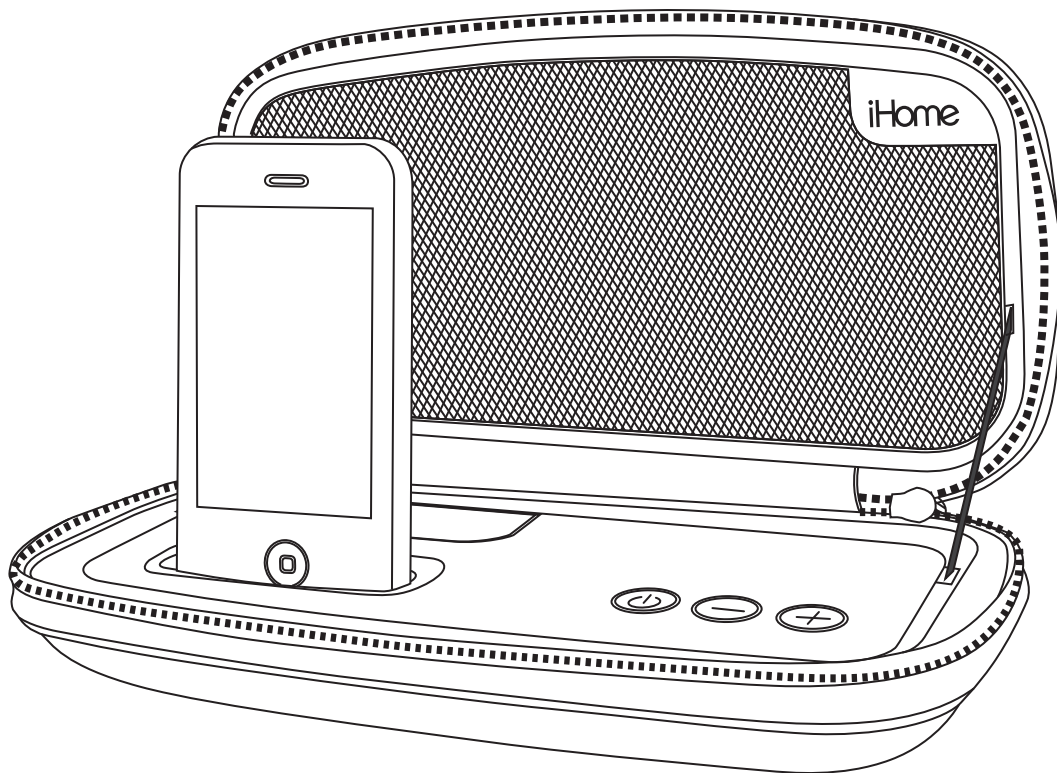

**Questions? Visit [www.ihomeaudio.com](http://www.ihomeaudio.com)**

## Table of Contents

iP57 Quick Start -----	1
Controls and Indicators -----	2
Getting Started -----	3
Playing and charging your iPhone/iPod -----	4
Using the Line-in Jack -----	4
A Consumer Guide to Product Safety -----	5
Trouble Shooting -----	6
Warranty Information -----	7

## Maintenance

- Place the unit on a level surface away from sources of direct sunlight or excessive heat.
- Protect your furniture when placing your unit on a natural wood and lacquered finish. A cloth or other protective material should be placed between it and the furniture.
- Clean your unit with a soft cloth moistened only with mild soap and water. Stronger cleaning agents, such as Benzene, thinner or similar materials can damage the surface of the unit.



TruBass and WOW technologies are incorporated under license from SRS Labs, Inc.

## FCC Information

**This device complies with Part 15 of the FCC Rules, operation is subject to the following two conditions: (1) This device may not cause harmful interference, and (2) this device must accept any interference received, including interference that may cause undesired operation.**

This equipment complies with the limits for a Class B digital device as specified in Part 15 of FCC Rules. These limits provide reasonable protection against radio and TV interference in a residential area.

However, your equipment might cause TV or radio interference even when it is operating properly. To eliminate interference you can try one or more of the following corrective measures:

- Reorient or relocate the receiving antenna.
- Increase the distance between the equipment and the radio or TV.
- Use outlets on different electrical circuits for the equipment and the radio or TV.
- Consult your dealer or an experienced radio/television technician if the problem still exists.

Modifying or tampering with your system's internal components can cause a malfunction and might invalidate the system's warranty and void your FCC authorization to operate it.

This Class B digital apparatus complies with Canadian ICES-003.

Cet appareil numérique de la classe B est conforme à la norme NMB-003 du Canada.

# iP57 Quick Start

## 1:AC adaptor

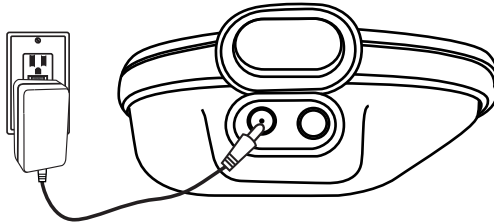

Connect AC adaptor to the DC jack on the left of the unit and plug the other end into a working wall socket. The internal battery (and docked iPod/iPhone) will charge.

Use this insert	iPod touch 2G insert 16	iPhone 4 insert 19	iPod nano 6G/touch 4G insert 20
For this iPhone/iPod	iPod touch 2G/3G	iPhone 4	nano 6G/ iPod touch 4G

**NOTE: If you do not have an insert for your iPhone/iPod, please visit [www.ihomeaudio.com](http://www.ihomeaudio.com) or call iHome toll free at 800-288-2792 to purchase one**

## 2:inserts

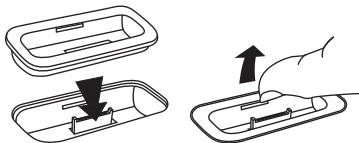

Select the dock insert for your iPod/iPhone model from the table above and place insert in dock. To remove insert, place thumbnail in slot and gently pull upwards.

## 3:iPod/iPhone

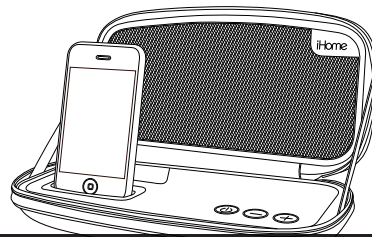

Gently place iPod/iPhone on the connector plug on dock. Press the **Power Button**. Unit and iPod/iPhone will turn on. Adjust volume by pressing the **+** or **- Button**.

# Controls and Indicators

## Front Panel

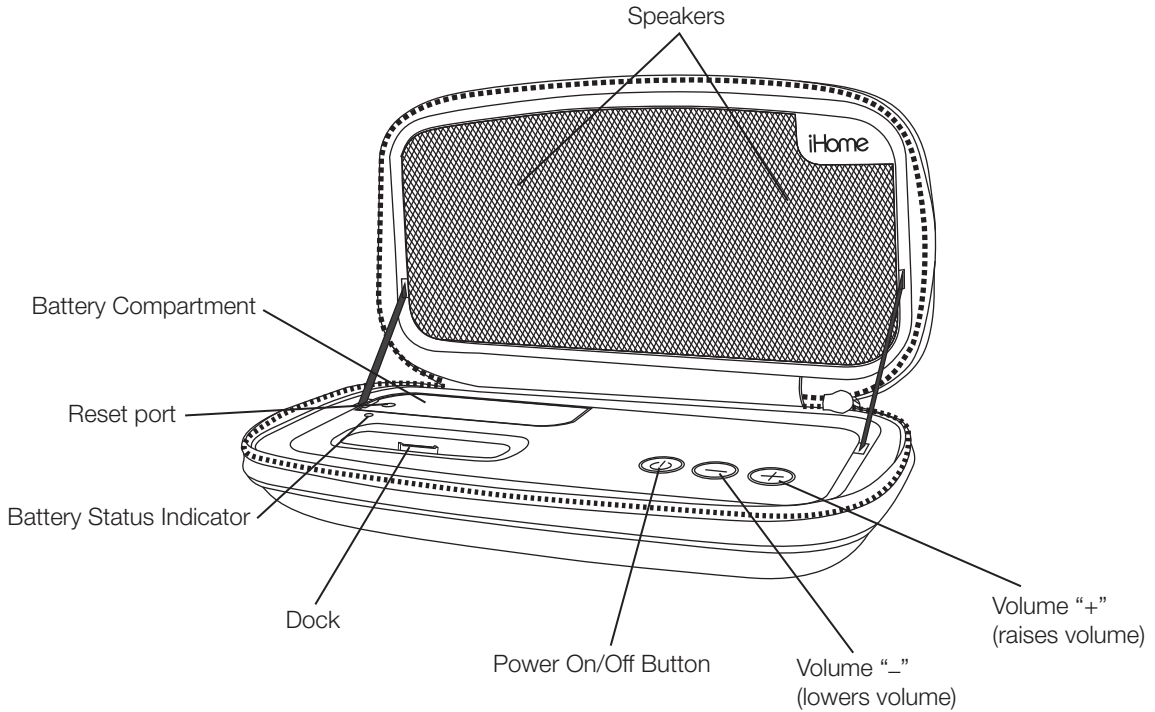

## Side Panel

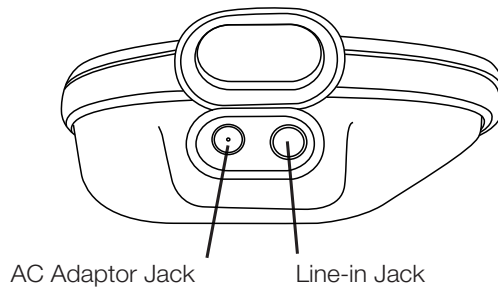

## Getting Started

Thank you for purchasing the iHome iP57 Portable Rechargeable Speaker System for your iPhone and iPod. Designed specifically to work with your iPhone and iPod, this system provides high quality audio performance that goes anywhere. Please read this instruction book carefully before the unit is operated and keep it for future reference.

### Install iPhone/iPod Insert

Your iP57 comes with 3 removable inserts to ensure your iPhone/iPod fits properly in the Dock. Please see table on page 1 to select your insert. While inserts provide the best stability and are recommended, if you do not have an insert for your particular iPhone or iPod model, you can safely dock it without an insert, provided you always do so gently and carefully. If you wish to purchase an insert for your iPhone or iPod, please visit [www.ihomeaudio.com](http://www.ihomeaudio.com).



### Connect to Power

#### Connect AC Adaptor

Connect the AC adaptor cable plug into the jack on the left of the unit, then plug the AC adaptor into the wall outlet. When connected to the AC adaptor, the iP57 charges your iPhone/iPod.

**Note:** Your iPhone/iPod will NOT charge when the unit is operating on the internal rechargeable battery. This AC adaptor is for use with the iP57 only. To avoid damage, do not use unit with other adaptor.

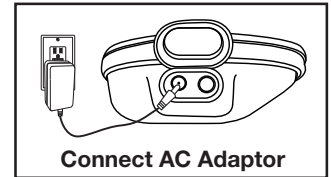

### Charging the Internal Battery

This unit has an internal rechargeable lithium ion battery. The battery condition indicator is located on top of the unit to the left of the dock. When fully charged, the indicator will steadily glow green. When the battery needs charging, the indicator will change to red. To charge, connect the unit to a working AC outlet. The indicator will blink green while charging. The first time you charge the internal battery, please allow up to 12 hours to fully charge.

### End-Of-Life Battery Disposal Instructions

This unit uses an internal Lithium-ion battery that may be recharged hundreds of times and should last the lifetime of the device. The rechargeable battery is also recyclable. If you find that the battery in your unit will no longer maintain a charge, please contact us at [www.ihomeaudio.com](http://www.ihomeaudio.com) for repair information. DO NOT attempt to replace the battery yourself. If you decide that you do not want to have your unit repaired, please do not dispose of the unit with your normal household trash. Contact your local recycling center for information on the proper disposal of products containing rechargeable batteries. In addition, many electronics stores, possibly including the store where you purchased your unit, are now accepting used electronics products containing recyclable batteries and other hazardous materials, for proper disposal and/or recycling.

### Caution: The Battery used in this device may present a risk of fire, explosion or chemical burn if mistreated

Battery shall not be exposed to excessive heat such as fire, or the like. Do not use or charge the battery if it appears to be leaking, discolored, deformed, or in any way abnormal. Do not leave your battery discharged or unused for extended periods of time. When batteries are misused, they may explode or leak, causing burns and personal injury. If your battery leaks, use normal precaution and cease using the product right away.

## Playing and Charging your iPhone or iPod

1. Place proper insert for your iPhone/iPod (see insert table on page 1) in Dock, then gently dock iPhone/iPod. When docked and connected to AC power, the iPhone/iPod will charge until fully charged. **The unit will not charge iPhone or iPod when operating on internal battery.** The iPhone/iPod will not overcharge.
2. Press the **⏻ Button** to play iPhone/iPod and the button will light up to show unit is on.
3. Press the **+ or - Button** to adjust unit volume.
4. To switch off the unit, press the **⏻ Button** once more. It will switch off both the unit and your iPhone/iPod.

NOTE: Docking an already playing iPhone or iPod will also turn on your unit after a moment. Similarly, undocking a playing iPhone or iPod will turn the unit off.

## Using the Line-in Jack

1. Plug one end of an audio patch cord (available at [www.ihomeaudio.com](http://www.ihomeaudio.com)) into the headphone or line-out jack on your audio device and the other end of the patch cord into the Line-in Jack on the left of this unit.
2. Turn on your audio device and put it in play mode.
2. Press the **⏻ Button** to turn the unit on and begin playback on your external audio device. The button will light up to show unit is on.
3. Press the **+ or - Button** to adjust the volume. You may need to adjust your device's volume too.
4. To switch off the unit, just press the **⏻ Button** again. Remember to switch off your device too.

NOTE: Do not connect and play an audio device to the line-in jack while playing an iPhone or iPod in the dock or you will hear both sound sources at once.

## Resetting the Unit

This unit was designed with a special surge protection circuit to prevent permanent damage to the unit in the event of an unexpected power surge. If your unit appears to be 'locked up' and is not operating normally, and you know that the battery is properly charged, use a straightened paper clip, toothpick, or similar object to press the RESET button, located on the top of the battery compartment cover near the battery indicator. This will unlock the unit and restore the original factory default settings.

# IMPORTANT SAFETY INSTRUCTIONS

When used in the directed manner, this unit has been designed and manufactured to ensure your personal safety. However, improper use can result in potential electrical shock or fire hazards. Please read all safety and operating instructions carefully before installation and use, and keep these instructions handy for future reference. Take special note of all warnings listed in these instructions and on the unit.

1. **Water and Moisture** – The unit should not be used near water. For example: near a bathtub, washbowl, kitchen sink, laundry tub, swimming pool or in a wet basement.
2. **Ventilation** – The unit should be situated so that its location or position does not interfere with its proper ventilation. For example, it should not be situated on a bed, sofa, rug or similar surface that may block ventilation openings. Also, it should not be placed in a built-in installation, such as a bookcase or cabinet, which may impede the flow of air through the ventilation openings.
3. **Heat** – The unit should be situated away from heat sources such as radiators, heat registers, stoves or other appliances (including amplifiers) that produce heat.
4. **Power Sources** – The unit should be connected to a power supply only of the type described in the operating instructions or as marked on the appliance.
5. **Power-Cable Protection** – Power supply cables should be routed so that they are not likely to be walked on or pinched by items placed upon or against them. It is always best to have a clear area from where the cable exits the unit to where it is plugged into an AC socket.
6. **Cleaning** – The unit should be cleaned only as recommended. See the Maintenance section of this manual for cleaning instructions.
7. **Objects and Liquid Entry** – Care should be taken so that objects do not fall and liquids are not spilled into any openings or vents located on the product.
8. **Attachments** – Do not use attachments not recommended by the product manufacturer.
9. **Lightning and Power Surge Protection** – Unplug the unit from the wall socket and disconnect the antenna or cable system during a lightning storm or when it is left unattended and unused for long periods of time. This will prevent damage to the product due to lightning and power-line surges.
10. **Overloading** – Do not overload wall sockets, extension cords, or integral convenience receptacles as this can result in a risk of fire or electric shock.
11. **Damage Requiring Service** – The unit should be serviced by qualified service personnel when:
  - A. the power supply cable or plug has been damaged.
  - B. objects have fallen into or liquid has been spilled into the enclosure.
  - C. the unit has been exposed to rain.
  - D. the unit has been dropped or the enclosure damaged.
  - E. the unit exhibits a marked change in performance or does not operate normally.
12. **Periods of Nonuse** – If the unit is to be left unused for an extended period of time, such as a month or longer, the power cable should be unplugged from the unit to prevent damage or corrosion.
13. **Servicing** – The user should not attempt to service the unit beyond those methods described in the user's operating instructions. Service methods not covered in the operating instructions should be referred to qualified service personnel.

**Questions? Visit [www.ihomeaudio.com](http://www.ihomeaudio.com)**



## Trouble Shooting

Symptom	Possible Problem	Solution
Unit doesn't respond (no power)	AC adaptor isn't plugged into a wall outlet or the connector is not plugged into the power supply jack on the back of the dock	Plug the AC adaptor into a wall outlet and plug the connector into the supply jack on the unit
	Wall outlet is not functioning or switched off	Plug another device into the same outlet to confirm the outlet is working. Make sure any associated power switch is ON
	Batteries are weak or dead	Charge internal battery by connecting AC adaptor to working outlet until battery indicator glows steadily.
iPod/iPhone does not dock properly	Using no or wrong iPod/iPhone insert	Make sure the dock insert is the proper fit for your iPod/iPhone
	iPod/iPhone not docked properly	Remove your iPod/iPhone from the dock and check for obstruction on the connectors in the dock and on your iPod/iPhone. Make sure there is no "skin" or case on the iPod/iPhone. Then reseat it in the dock.
iPod/iPhone does not respond to the unit	iPod/iPhone is not docked properly	Remove your iPod/iPhone from the dock and check for obstruction on the connectors in the dock and on your iPod. Then reseat it in the dock.
	Your iPod/iPhone software is too old	Upgrade software on your iPod/iPhone via iTunes
	iPod/iPhone is locked up	Please make sure your iPod/iPhone is working properly before docking into the unit. Please refer to your iPod/iPhone manual for details.
	Using 1 <sup>st</sup> or 2 <sup>nd</sup> generation iPod, iPod shuffle or other devices.	Unit cannot control those iPod models or other devices. Use the Line-in jack to play these devices.
iPod/iPhone does not come on immediately	If your iPod/iPhone is not used for some time, it may enter deep sleep mode	Press the Menu button on your iPod/iPhone
	iPod/iPhone battery is run down or is too weak	Charge your iPod/iPhone for about 5 minutes
Unit operation is erratic	Unit requires reset	Insert the end of a paperclip or similar into the Reset port located next to the AC jack and press in for a few seconds to restore the unit to factory default settings. Doing so will overwrite any current settings.

# Limited 1 Year Warranty Information

---

iHome Products, a division of SDI Technologies Inc. (hereafter referred to as SDI Technologies), warrants this product to be free from defects in workmanship and materials, under normal use and conditions, for a period of 1 year from the date of original purchase.

Should this product fail to function in a satisfactory manner, it is best to first return it to the store where it was originally purchased. Should this fail to resolve the matter and service still be required by reason of any defect or malfunction during the warranty period, SDI Technologies will repair or, at its discretion, replace this product without charge (except for a \$10.00 charge for handling, packing, return UPS/postage, and insurance). This decision is subject to verification of the defect or malfunction upon delivery of this product to the Factory Service Center listed below. The product must include proof of purchase, including date of purchase. The fee for service without proof of purchase is \$30.00.

Before returning this product for service, please first replace the batteries (if applicable) with fresh ones, as exhausted or defective batteries are the most common cause of problems encountered.

If service is still required:

1. Remove the batteries (if applicable) and pack the unit in a well padded, heavy corrugated box.
2. Enclose a photocopy of your sales receipt, credit card statement, or other proof of the date of purchase, if within the warranty period.
3. Enclose a check or money order payable to the order of SDI Technologies, for the sum of \$10.00 (\$30.00 without proof of purchase).
4. Send the unit prepaid and insured, to the Factory Service Center listed below.

## **Consumer Repair Department**

*SDI Technologies Inc.  
1330 Goodyear Drive  
El Paso, TX 79936-6420*

## Disclaimer of Warranty

**NOTE:** This warranty is valid only if the product is used for the purpose for which it was designed. It does not cover (i) products which have been damaged by negligence or willful actions, misuse or accident, or which have been modified or repaired by unauthorized persons; (ii) cracked or broken cabinets, or units damaged by excessive heat; (iii) damage to digital media players, CD's or tape cassettes (if applicable); (iv) the cost of shipping this product to the Factory Service Center and its return to the owner.

This warranty is valid only in the United States of America and does not extend to owners of the product other than to the original purchaser. In no event will SDI Technologies or any of its affiliates, contractors, resellers, their officers, directors, shareholders, members or agents be liable to you or any third party for any consequential or incidental damages, any lost profits, actual, exemplary or punitive damages. (Some states do not allow limitations on implied warranties or exclusion of consequential damages, so these restrictions may not apply to you.) This warranty gives you specific legal rights, and you may also have other rights which vary from state to state.

Your acknowledgement and agreement to fully and completely abide by the above mentioned disclaimer of warranty is contractually binding to you upon your transfer of currency (money order, cashier's check, or credit card) for purchase of your SDI Technologies product.

© 2011 SDI Technologies, Inc. All rights reserved

**Questions? Visit [www.ihomeaudio.com](http://www.ihomeaudio.com)  
or call 1-800-288-2792 Toll Free**

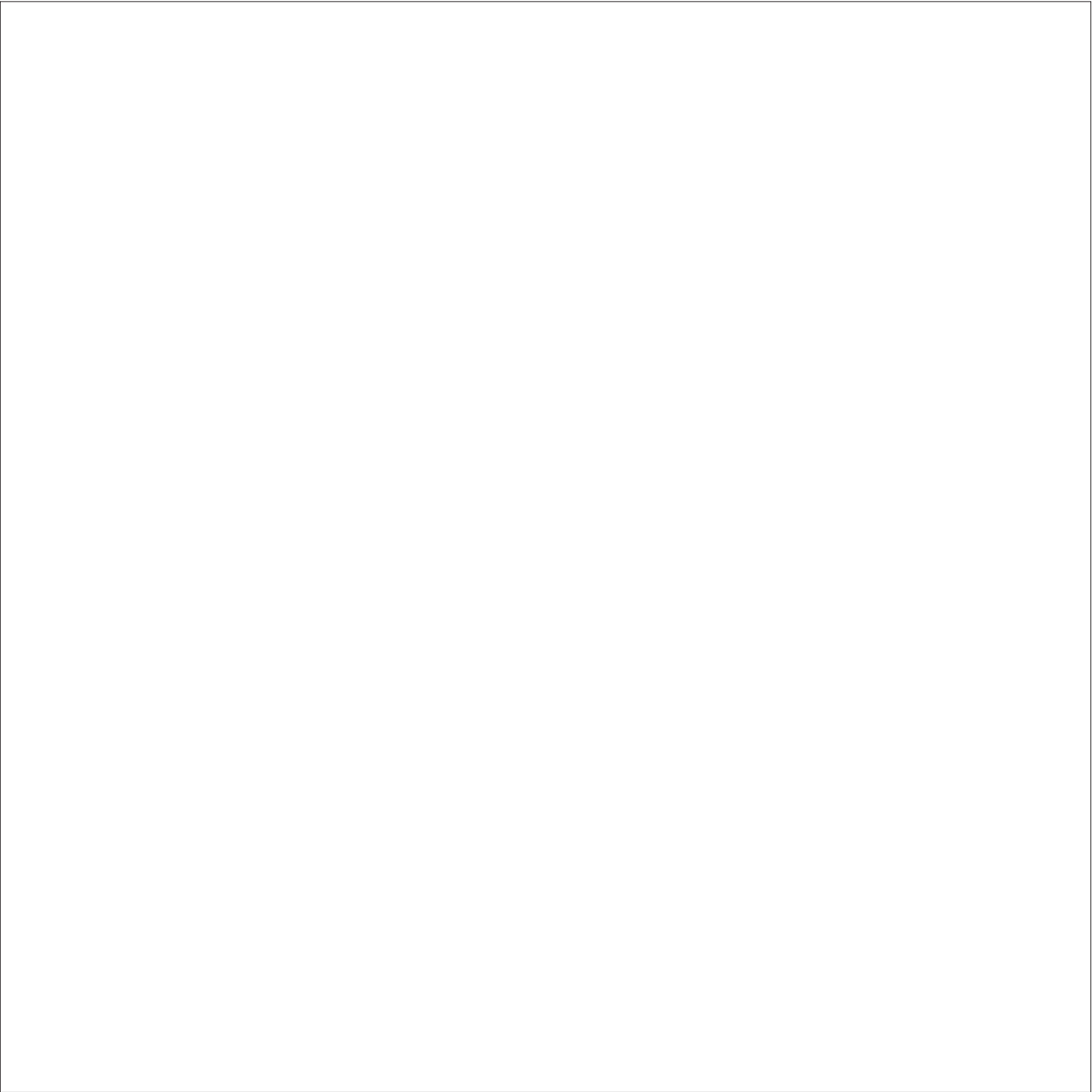

iHome®